

MACHEREY-NAGEL

BioFix[®] Lumi

Luminous bacteria tests



Water Analysis



Illuminating toxicity

- Quick and easy toxicity testing
- Certificate of conformity according to ISO 11348-2/-3
- Compatible with many luminometers

MACHEREY-NAGEL

www.mn-net.com



BioFix® Lumi luminous bacteria tests

Why luminous bacteria tests?

BioFix® Lumi brings light into the darkness

BioFix® Lumi luminous bacteria tests are rapid biological tests for determining acute toxicity in water samples. They are based on the natural bioluminescence of the marine bacteria *Aliivibrio fischeri*. The natural luminescence of the bacteria is inhibited by toxic substances and is therefore a parameter for the toxicity of a sample.

The test method is widely used in environmental analysis, particularly for the investigation of wastewater, industrial effluents, eluates from soils or sediments, and for monitoring systems in water supply networks.

Standard-compliant quality

The international standard DIN EN ISO 11348 regulates the performance of these tests, which are relevant for regulatory analyses in environmental agencies and wastewater analysis. It serves as an internationally recognized basis for quick and easy toxicity measurement for water and wastewater samples.

All BioFix® Lumi luminous bacteria tests come with a certificate of analysis in accordance with DIN EN ISO 11348-2 (liquid-dried) or DIN EN ISO 11348-3 (freeze-dried).

Your choice: liquid-dried or freeze-dried

BioFix® Lumi luminous bacteria (liquid-dried)

REF 945024

- Compliant with ISO 11348-2
- Comparable to LCK 482 from Hach *
- 400 determinations
- Incl. reactivation solution and standard



BioFix® Lumi luminous bacteria (freeze-dried)

REF 945022

- Compliant with ISO 11348-3
- Comparable to LCK 484 from Hach *
- 100 determinations
- Incl. reactivation solution and control



Wide range of pack sizes for more flexibility

REF	Product	Drying	Number of determinations
945002	BioFix® Lumi	freeze-dried	20 vials for 2000 determinations
945003	BioFix® Lumi	freeze-dried	10 vials for 1000 determinations
945006	BioFix® Lumi	freeze-dried	20 vials for 400 determinations
945007	BioFix® Lumi	freeze-dried	10 vials for 200 determinations
945021	BioFix® Lumi (Single Shot)	freeze-dried	20 vials for 400 determinations
945022	BioFix® Lumi (Multi Shot)	freeze-dried	10 vials for 100 determinations
945023	BioFix® Lumi	liquid-dried	10 vials for 200 determinations
945024	BioFix® Lumi	liquid-dried	20 vials for 400 determinations
945025	BioFix® Lumi	liquid-dried	10 vials for 100 determinations

* HACH is a registered trademark of HACH, Loveland, Colorado and is not affiliated with MACHERY-NAGEL GmbH & Co. KG.

BioFix[®] Lumi luminous bacteria tests

It's that easy!

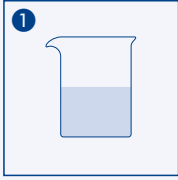

1
Prepare sample:
Check oxygen content
and pH value, adjust salt
content, prepare dilution
series if necessary

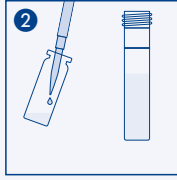

2
Reactivate luminous
bacteria: Defrost BioFix[®]
Lumi luminous bacteria
with the enclosed solution
and reactivate

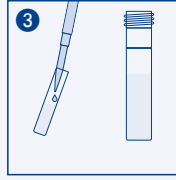

3
Dose the luminous
bacteria: Dose the
reactivated BioFix[®] Lumi
luminous bacteria into
measuring cuvettes

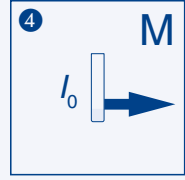

4
Measure the initial
luminescence I_0

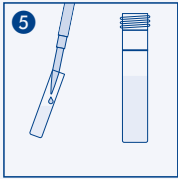

5
Add the sample / control
and mix

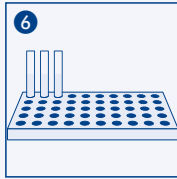

6
Incubate the luminous
bacteria at 15 °C

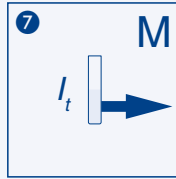

7
Measure the final
luminescence I_t



BioFix® Lumi luminous bacteria tests

BioFix® Lumi accessories

What you need for your BioFix® Lumi measuring station:

REF	Produkt
945601	BioFix® Lumi Diluent for diluting the sample / as control
945602	BioFix® Lumi Solution to adjust the osmotic pressure of the sample
916909	Piston pipette 1 – 5 mL
916916	Pipette tips1 – 5 mL
91677	Piston pipette 100 – 1000 µL
91676	Piston pipette 100 – 1000 µL
916912	Glass cuvettes
945013	BioFix® Lumi Rack for glass cuvettes
940008	BioFix® Lumi-10 or comparable luminometer (e. g. LUMISTox from Hach *)
	Incubator (15 °C)

* HACH ist eine eingetragene Marke der Firma HACH, Loveland, Colorado, und steht in keiner Verbindung mit der MACHERY-NAGEL GmbH & Co. KG.



© Gary (S. 1) · stock.adobe.com
KATENT100268 Flyer BioFix® Lumi luminous bacteria tests en3a

www.mn-net.com

MACHERY-NAGEL



Management System
EN ISO 13485:2016
ISO 9001:2015



www.tuv.com
ID 0000056401

MACHERY-NAGEL GmbH & Co. KG · Valenciener Str. 11 · 52355 Düren · Germany

DE +49 24 21 969-0 info@mn-net.com

CH +41 62 388 55 00 sales-ch@mn-net.com

FR +33 388 68 22 68 sales-fr@mn-net.com

US +1 888 321 62 24 sales-us@mn-net.com