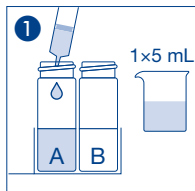

visicolor® ECO Chlordioxid

Chlorine dioxide / Dioxyde de chlore / Cloro dióxido

Messbereich / Range / Domaine de mesure / Rango

0.2 – 3.8 mg/L ClO₂

Probe
Sample
Echantillon
Muestra

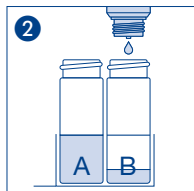

3 ∆ ClO₂-2

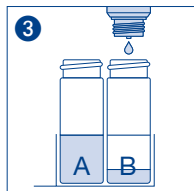

3 ∆ ClO₂-3

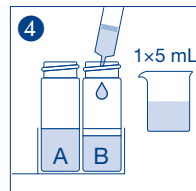

Probe
Sample
Echantillon
Muestra

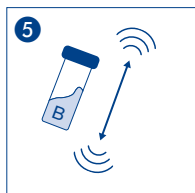

Schütteln
Shake
Agiter
Agitar

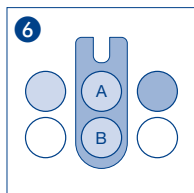

Messung
Measurement
Mesure
Medición

Nicht geeignet für Meerwasser
Not suitable for seawater
Ne convient pas à l'eau de mer
No es adecuado para el agua de mar



visocolor® ECO Chlordioxid

Chlorine dioxide / Dioxyde de chlore / Cloro dióxido

Bei einer Störung durch Chlor / In presence of chlorine interference / En cas d'interférence avec le chlore / En caso de interferencia de cloro:

Messbereich / Range / Domaine de mesure / Rango

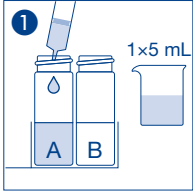
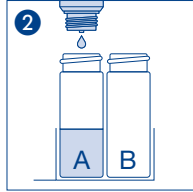
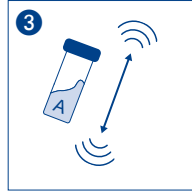
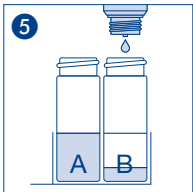
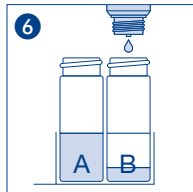
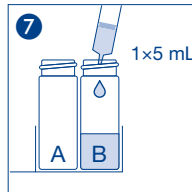
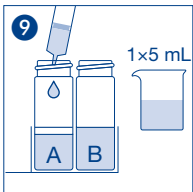
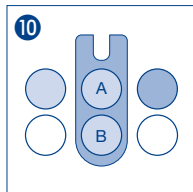
0.2 – 3.8 mg/L ClO₂Probe
Sample
Echantillon
Muestra2 ∆ ClO₂-1Schütteln
Shake
Agiter
AgitarWarten
Wait
Attendre
Espere3 ∆ ClO₂-23 ∆ ClO₂-3Probe
Sample
EchantillonSchütteln
Shake
Agiter
AgitarProbe
Sample
Echantillon
MuestraMessung
Measurement
Mesure
Medición

Nicht geeignet für Meerwasser
Not suitable for seawater
Ne convient pas à l'eau de mer
No es adecuado para el agua de mar

